

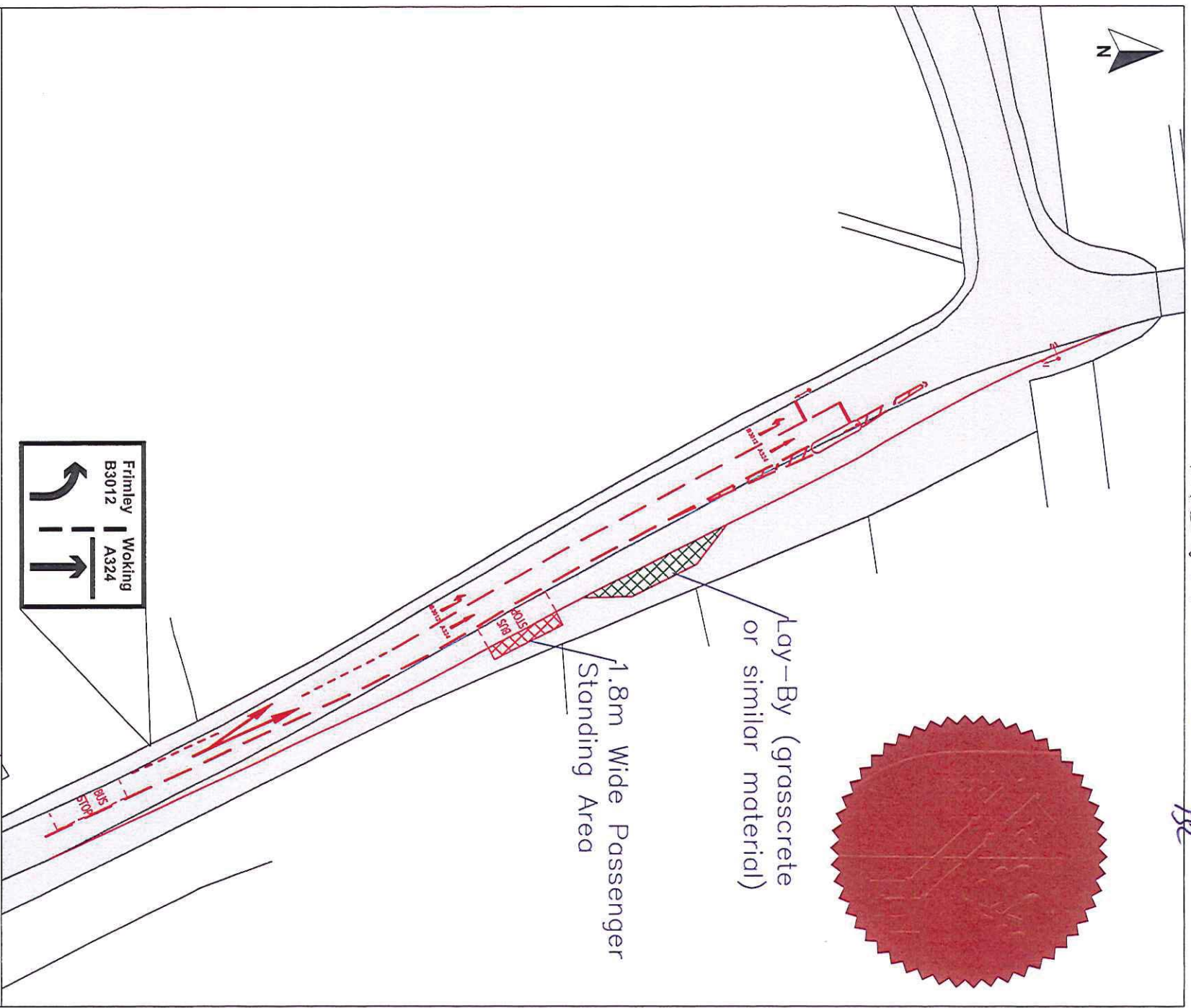



*R. C. Smith BA East H*  
*152*

*15*



- Key**
-  Proposed Scheme
  -  Primary Signal Head
  -  Secondary Signal Head
  -  Highway Land

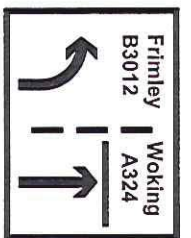

 Defence Infrastructure Organisation

Deepcut Princess Royal Barracks  
Planning Application  
Transport Assessment

Figure 11.8  
Gole Road/Dawney Hill Junction -  
Potential Limit of Highways Works